

Detachable packing container house

Installation Instructions

Frame structure installation:

- 1、Connect the four corner columns to the long and short beams at the bottom with M12*25 hexagon socket screws respectively. The corner columns and the outside of the beams should be flush. Do not tighten the screws too much. Support them after tightening.
- 2、Connect and fix the long and short beams on the top with M12*25 hexagon socket screws. Do not tighten the screws too much.
- 3、Place nine 50mm*100mm bottom square tubes into the slots of the bottom beam one by one, and use 70mm*10mm screws to fix the square tubes and the bottom beam and tighten them.
- 4、Use a tape measure to pull the diagonal line to correct the bottom frame. If the values are the same, the horizontal calibration is complete, and then tighten the screws at the top and bottom.
- 5、Install the downpipe and fix it to the column with a flat-head cross 4.8*70 self-drilling screw.
- 6、The joints between the top long and short beams and corner columns need to be glued to prevent water leakage.



Cutting of wall panels:

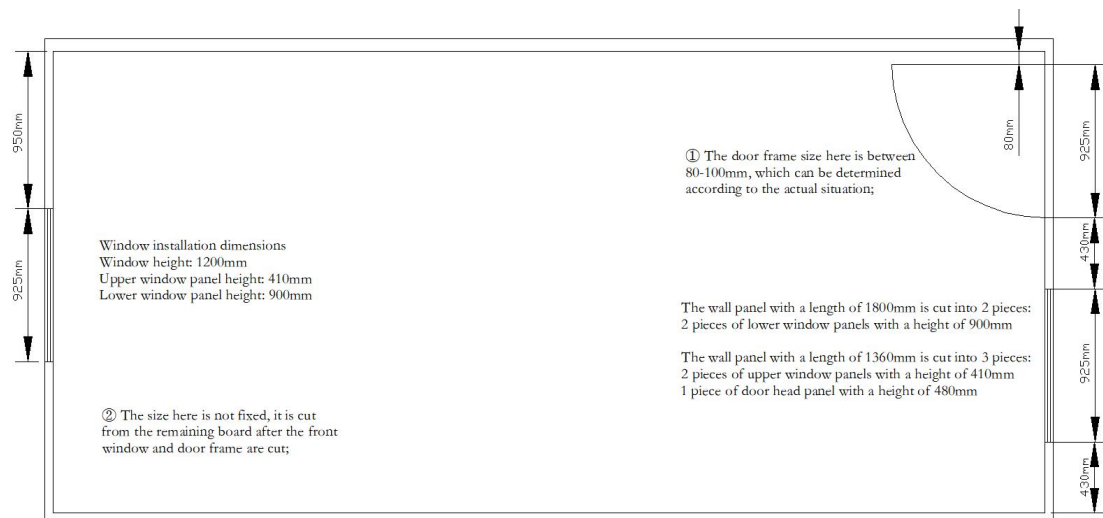

A standard set of quick-break boxes requires 15 wall panels of 2510mm long and 950mm wide, 1 wall panel of 1800mm long and 950mm wide, and 1 wall panel of 1310mm long and 950mm wide.

7、 The wall panels of the quick-break box on the 6-meter length direction need 6 whole panels each, a total of 12 wall panels, no cutting is required.

8. The side with windows and doors needs to be cut into 2 pieces. The cutting dimensions in the width direction are as follows:

(A). Cut the 2560mm long * 950mm wide wallboard into 3 pieces, two 430mm wallboards, and the remaining middle piece (can be used as a door frame or discarded); one of the 430mm wallboards is used as a door frame, and the rock wool inside needs to be removed, and then a 20mm * 40mm square tube is put in to fix it with a small white nail. The middle part should be pressed down one centimeter before fixing it to facilitate the installation of the lock; the other 430mm wallboard is used as a wallboard on the other side of the window on the same side.

(B). Cut the wallboard of 2510mm long and 950mm wide into 80mm and 870mm (the cutting here is flexible and can be cut according to the on-site installation conditions); the 80mm wallboard is used as the door frame of the front window (the size of the door frame is 80-100mm); the remaining 870mm is used as the wallboard of the rear window (cut according to the on-site installation conditions).

9. The cutting dimensions of the window wall panels in the length direction are as follows: Cut the 1800mm long wall panel into two 900mm pieces for the upper wall panels of the windows; cut the 1310mm long wall panel into three pieces, two 410mm pieces for the upper and lower wall panels of the windows, and 480mm for the wall panel above the door head.

Siding, window and door installation

Note:

(A). Since there should be a gap between the wall panels, there will be some deviation in the size. The cutting size can be modified according to the actual situation.

(B). To facilitate the installation of the floor, the floor can be installed simultaneously after the two wall panels are installed.

10、 Installation of two wall panels in the length direction: Fix the wall panels close to the columns with flat-head cross 4.8*70 self-drilling screws, and then install and tighten them in sequence without leaving any gaps.

11、 Installation of the wall panels on the side with only windows in width direction: first install and fix the wall panels with length 2510mm*width 950mm; then install the lower wall panels of the windows, fix the side of the wall panels with the connection with the upper wall panels with small white nails, then insert the window into the slot, make sure to insert it into the wall panels and fasten it; then install the upper wall panels of the windows, fix the side connection with small white nails, and fix the connection with the top beam with 75mm self-tapping screws; the last wall panel needs to be measured on site to determine the width of the wall panel, install it, and fix the edge close to the column with 75mm self-tapping screws.

12、 Installation of the wall panel with windows and doors in the width direction:

(A). First install the 80mm wall panel (the outer frame of the wall panel is 30mm away from the column), fix it with a flat-head cross 4.8*70 self-drilling screw, and use it as the door frame.

(B). install the door, insert the door frame slot into the door frame, fasten it and fix it with screws; take the cut 480mm wall panel and install it on the upper wall panel of the door, and

then fix it with small white nails.

(C). then install the 430mm wall panel containing square tubes on the other side of the door (containing door locks), fix it with small white nails and use a level to check whether the door and the frame are vertical. Keep it vertical so that the door lock can be used normally; install the windows in turn (the method here is the same as step 9) and the last 430mm wall panel.
(D).Install the door lock.

Floor installation:

13、 Put two 20mm*20mm square tubes on the short bottom beam and fix them with screws so that they are on the same plane as the nine 50mm*100mm square tubes.

14、 To install the floor, lay out 5 pieces in sequence, arrange them tightly (you can use a crowbar to pry them tight), and fix them with self-tapping screws.

Top structure installation:

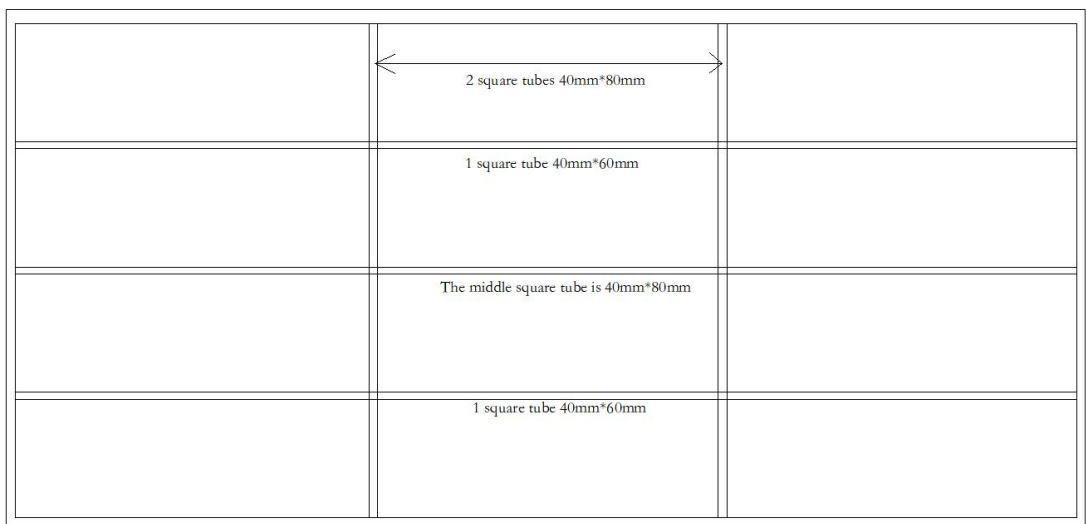

15、 First install two 40mm*80mm square tubes in the top width direction, and fix the two ends in the clamps reserved in the long beam with small white nails.

16 、 Install three square tubes in the length direction, of which the middle one is 40mm*80mm, and the two sides are 40mm*60mm, so that the middle will be 20mm higher than the two sides, which is conducive to drainage; then, use 100mm self-tapping screws to fix the intersection of the two square tubes from top to bottom.

17、 Install 40mm*40mm angle aluminum around the top of the wall panel and fix it with screws.

18、 Place 6 pieces of 831 ceiling tiles on the angle aluminum, and the 7th piece needs to be cut according to the site conditions before installation.

19、 The roof is covered with rolled cotton.

20、 Install 6 980 roof tiles and place them in order; fix the roof tiles with 25mm self-tapping screws at both ends, and the tiles need to be overlapped by one grid to prevent water leakage; knock down the edges of the roof tiles with a hammer to prevent rainwater from entering.

21、 When installing the corner column package, first draw a line to locate the buckle position, then fix the buckle with screws, and finally buckle the package and glue it.

22、 Apply glue to the outside of the frame, doors, windows, and roof (including screw holes) to prevent water leakage.